

Memorial Campus
Level 1

509 Biltmore Avenue
 Asheville, NC 28801
 (828) 213-1050

The room # is _____

Take the _____ Elevator to level _____

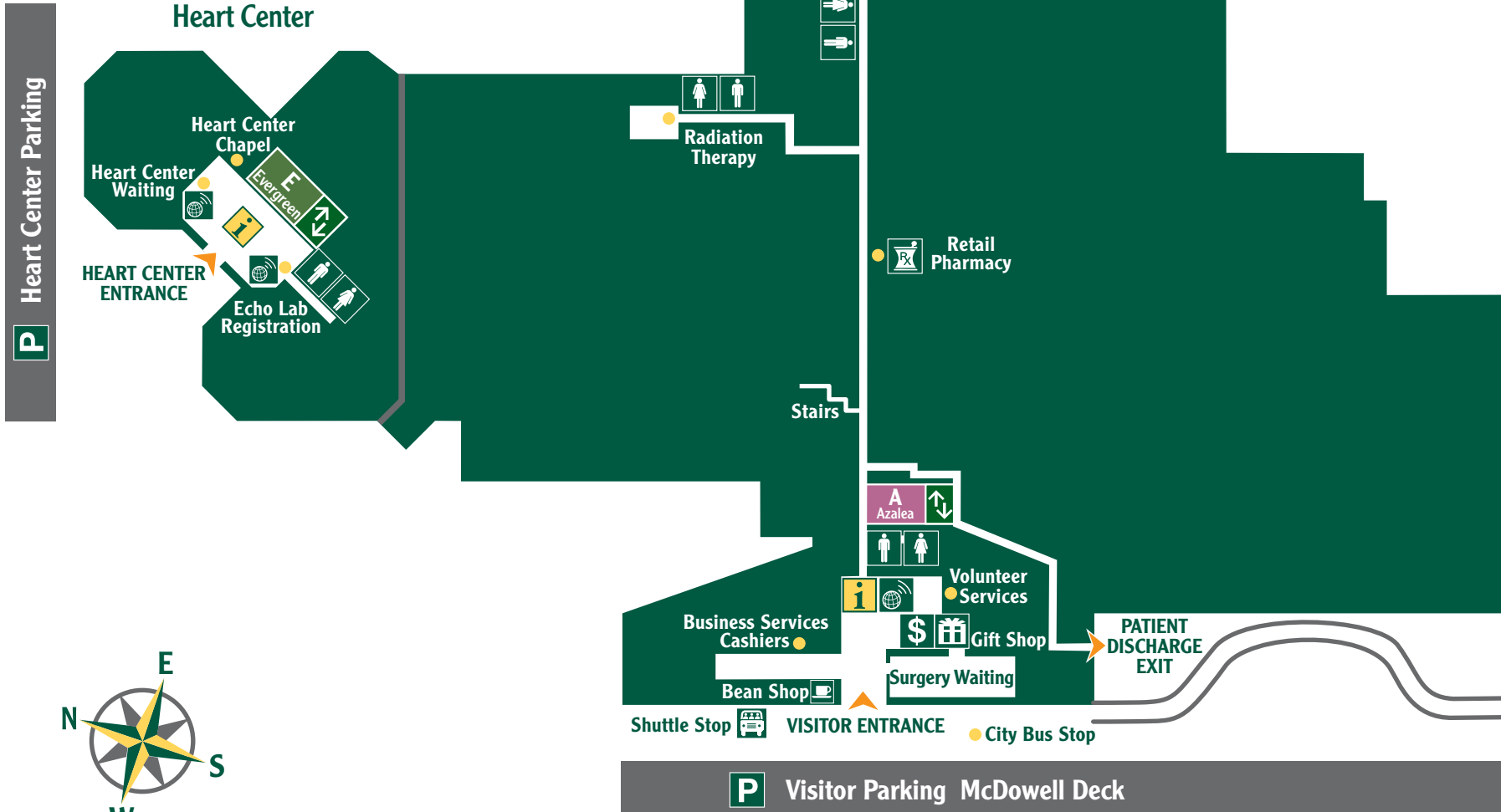

A Azalea	E Evergreen	G Geranium	Building Entrance	Emergency Entrance	Emergency	Information	Cafeteria	Restrooms	Secure Access	Retail Pharmacy	Gift Shop	Bean Shop	ATM	Internet Access	Parking	Campus Shuttle

Memorial Campus Level 2

509 Biltmore Avenue
Asheville, NC 28801
(828) 213-1050



P Patient/Outpatient Parking Biltmore Deck

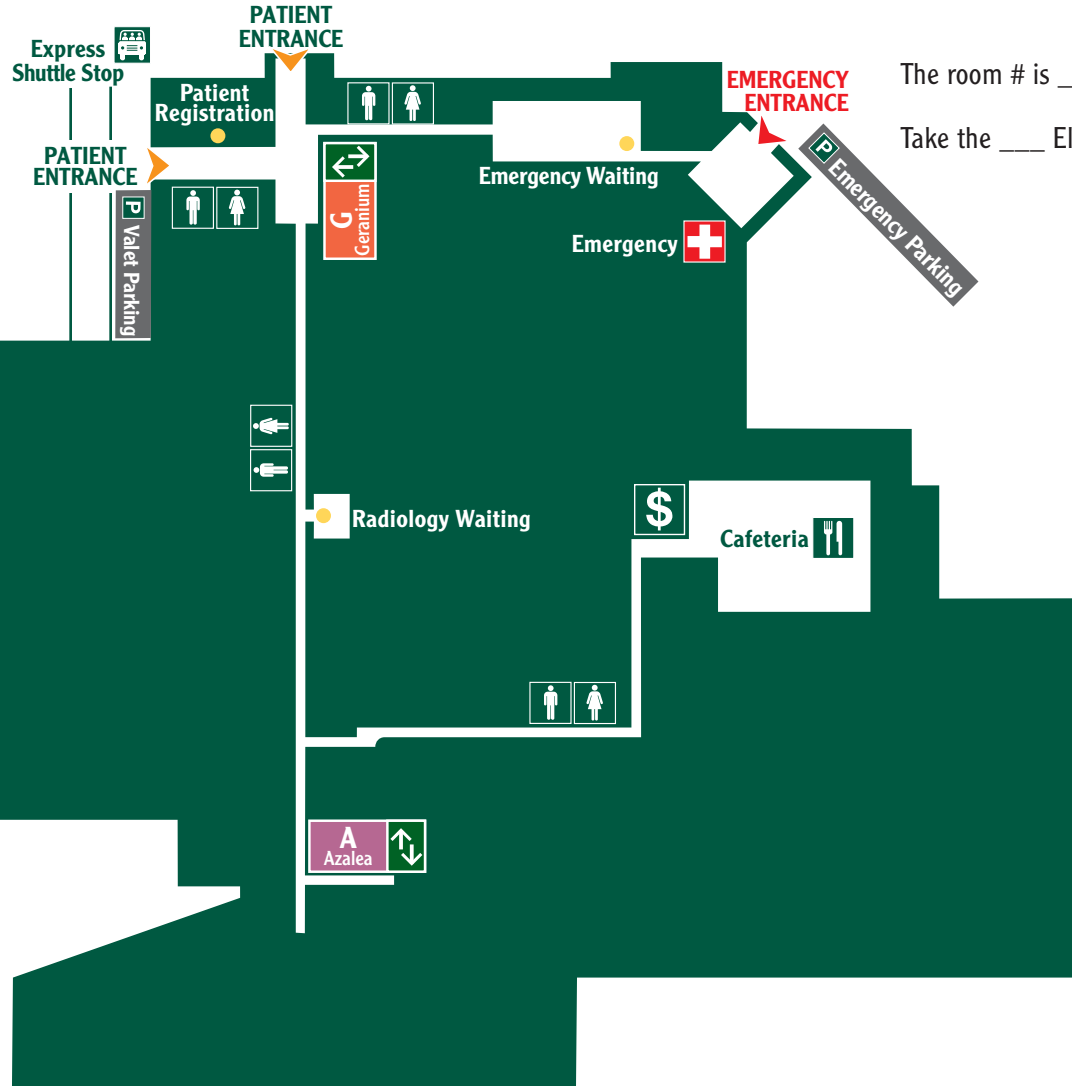
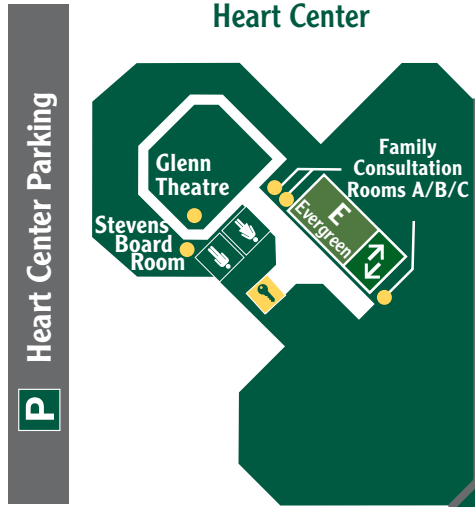

The room # is _____
Take the ____ Elevator to level ____



A Azalea	E Evergreen	G Geranium	Building Entrance	Emergency Entrance	Emergency	Information	Cafeteria	Restrooms	Secure Access	Retail Pharmacy	Gift Shop	Bean Shop	ATM	Internet Access	Parking	Campus Shuttle
-----------------	--------------------	-------------------	-------------------	--------------------	-----------	-------------	-----------	-----------	---------------	-----------------	-----------	-----------	-----	-----------------	---------	----------------

Memorial Campus Level 3

509 Biltmore Avenue
 Asheville, NC 28801
 (828) 213-1050

♥ Directions to the Heart Center:

- Take the A Elevator* to **level 3**.
- Exit the A Elevator and turn right.
- Follow the signs to the **Heart Center/E Elevator**.
- Take the E Elevator to **level 1** and get a visitor's pass.

*Please use the A Elevator to return to the Visitor's entrance on level 1 or to access the Cafeteria located on level 2.

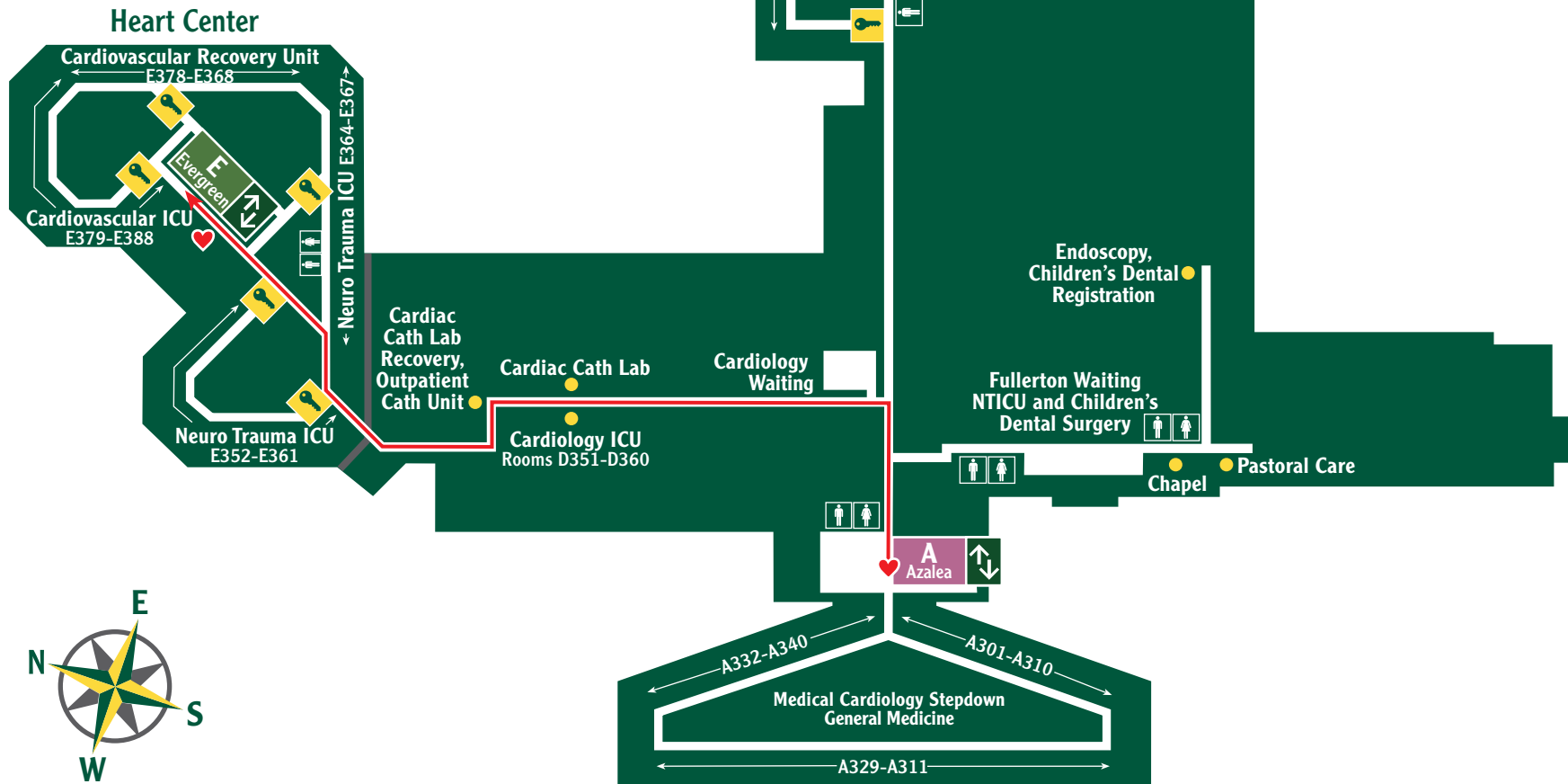

The room number is _____

Take the _____ Elevator to level 3

Elevators			Building Entrance	Emergency Entrance	Emergency	Information	Cafeteria	Restrooms	Secure Access	Retail Pharmacy	Gift Shop	Bean Shop	ATM	Internet Access	Parking	Campus Shuttle

Memorial Campus
Level 4

509 Biltmore Avenue
 Asheville, NC 28801
 (828) 213-1050

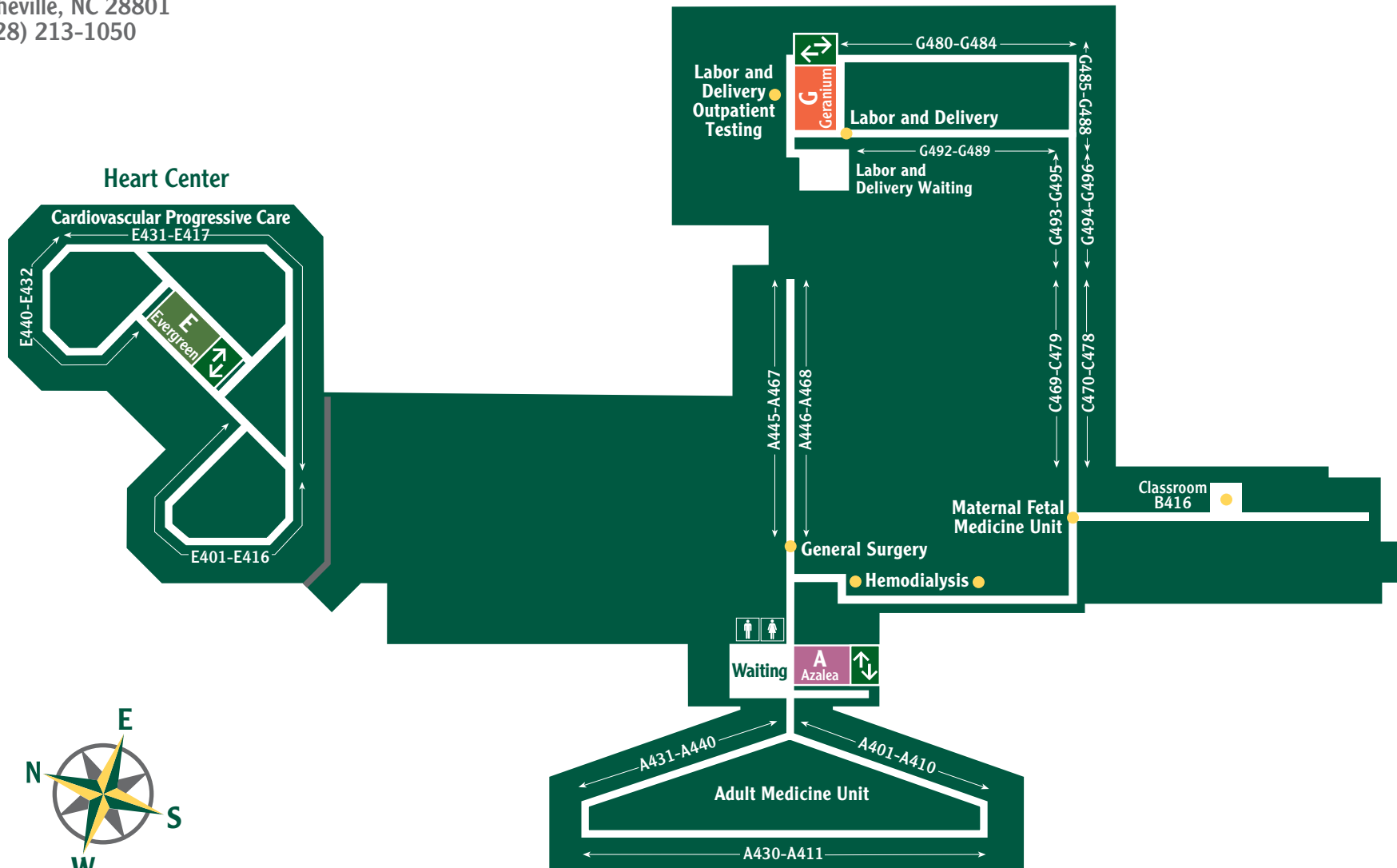

Azalea	Evergreen	Geranium	Building Entrance	Emergency Entrance	Emergency	Information	Cafeteria	Restrooms	Secure Access	Retail Pharmacy	Gift Shop	Bean Shop	ATM	Internet Access	Parking	Campus Shuttle

Memorial Campus
Level 5

509 Biltmore Avenue
 Asheville, NC 28801
 (828) 213-1050

The room # is _____

Take the _____ Elevator to level _____

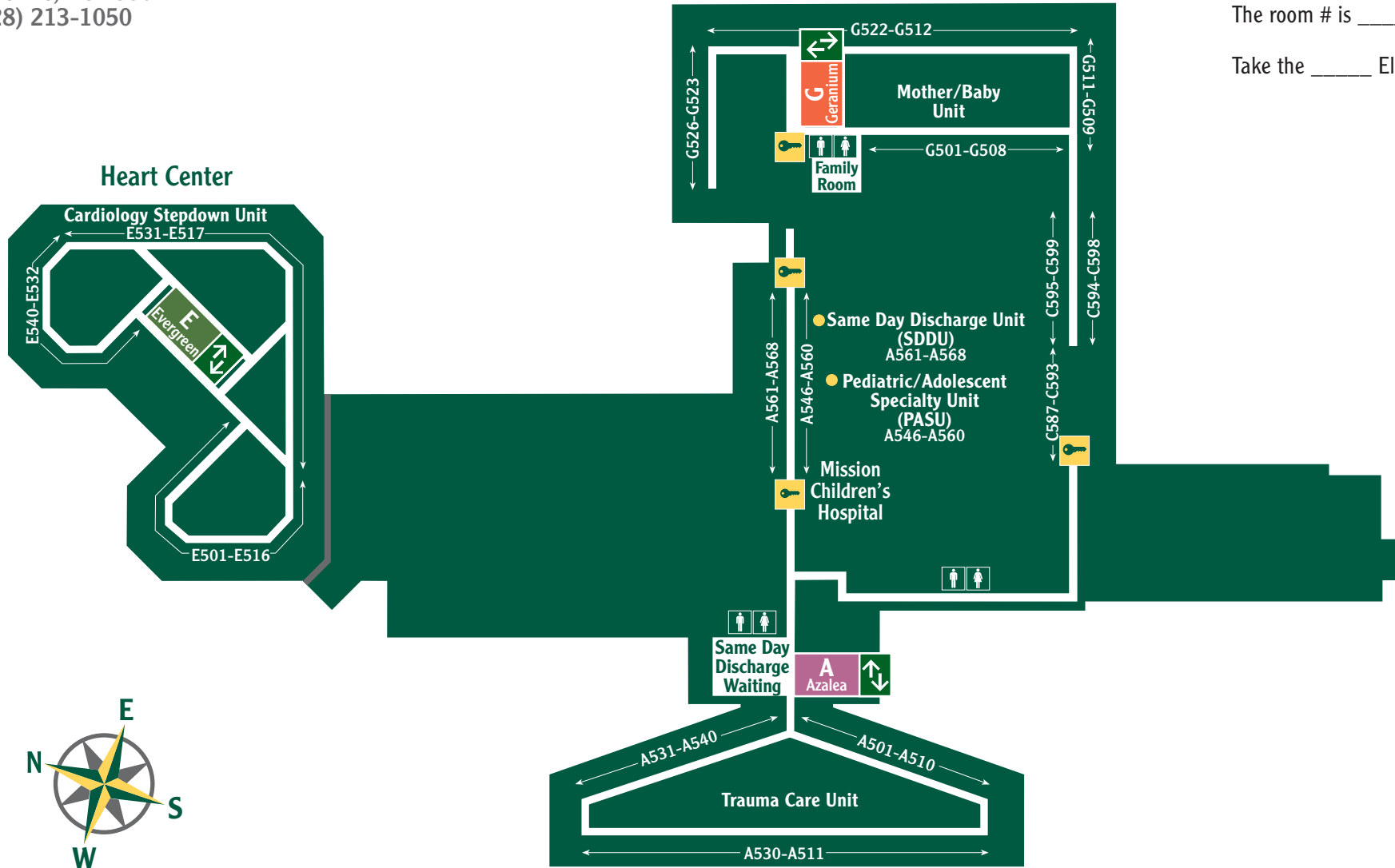

A Azalea	E Evergreen	G Geranium														
Elevators			Building Entrance	Emergency Entrance	Emergency	Information	Cafeteria	Restrooms	Secure Access	Retail Pharmacy	Gift Shop	Bean Shop	ATM	Internet Access	Parking	Campus Shuttle

Memorial Campus
Level 6

509 Biltmore Avenue
 Asheville, NC 28801
 (828) 213-1050

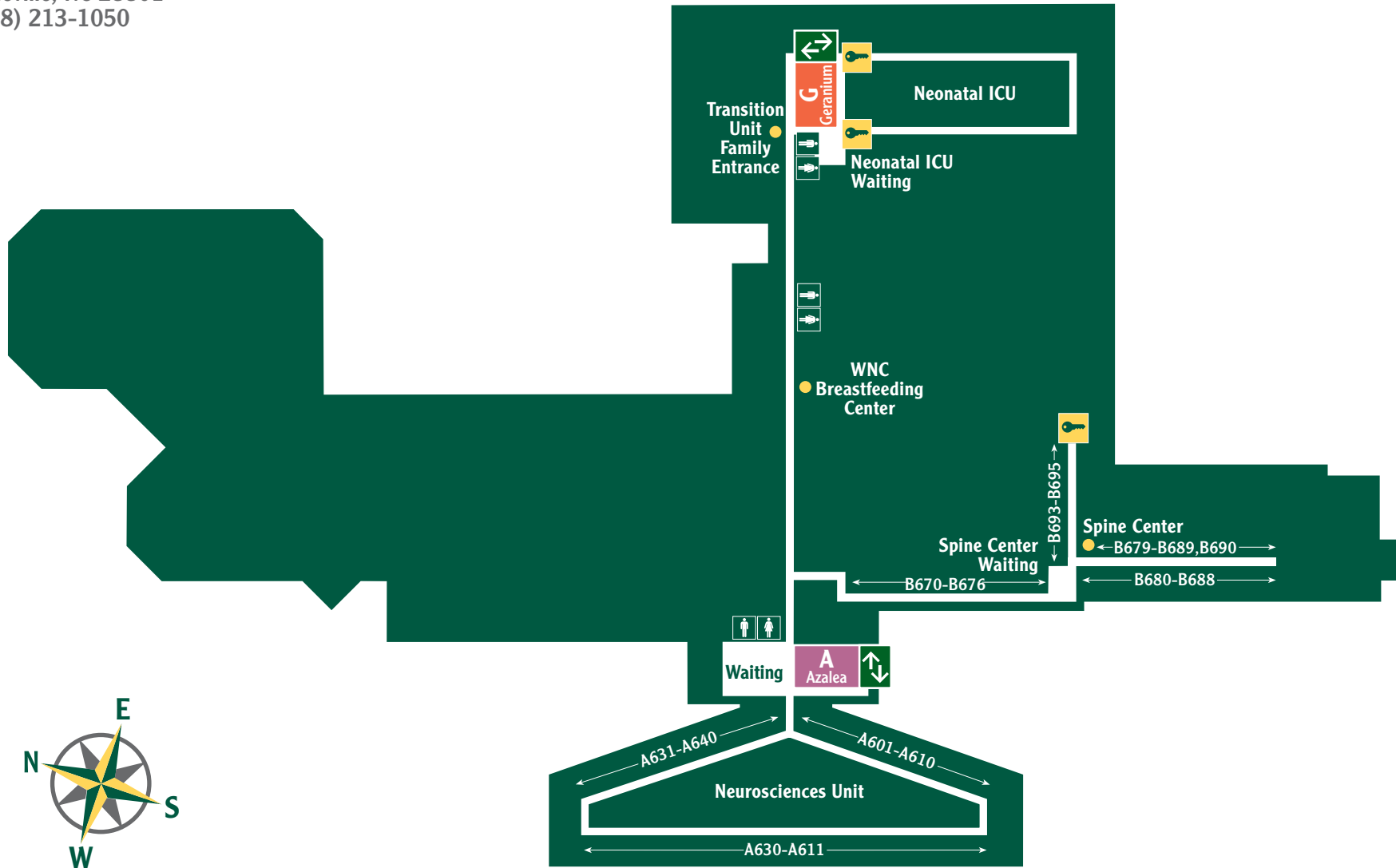

Azalea	Evergreen	Geranium	Building Entrance	Emergency Entrance	Emergency	Information	Cafeteria	Restrooms	Secure Access	Retail Pharmacy	Gift Shop	Bean Shop	ATM	Internet Access	Parking	Campus Shuttle

Memorial Campus
Level 7

509 Biltmore Avenue
 Asheville, NC 28801
 (828) 213-1050

The room # is _____

Take the _____ Elevator to level _____

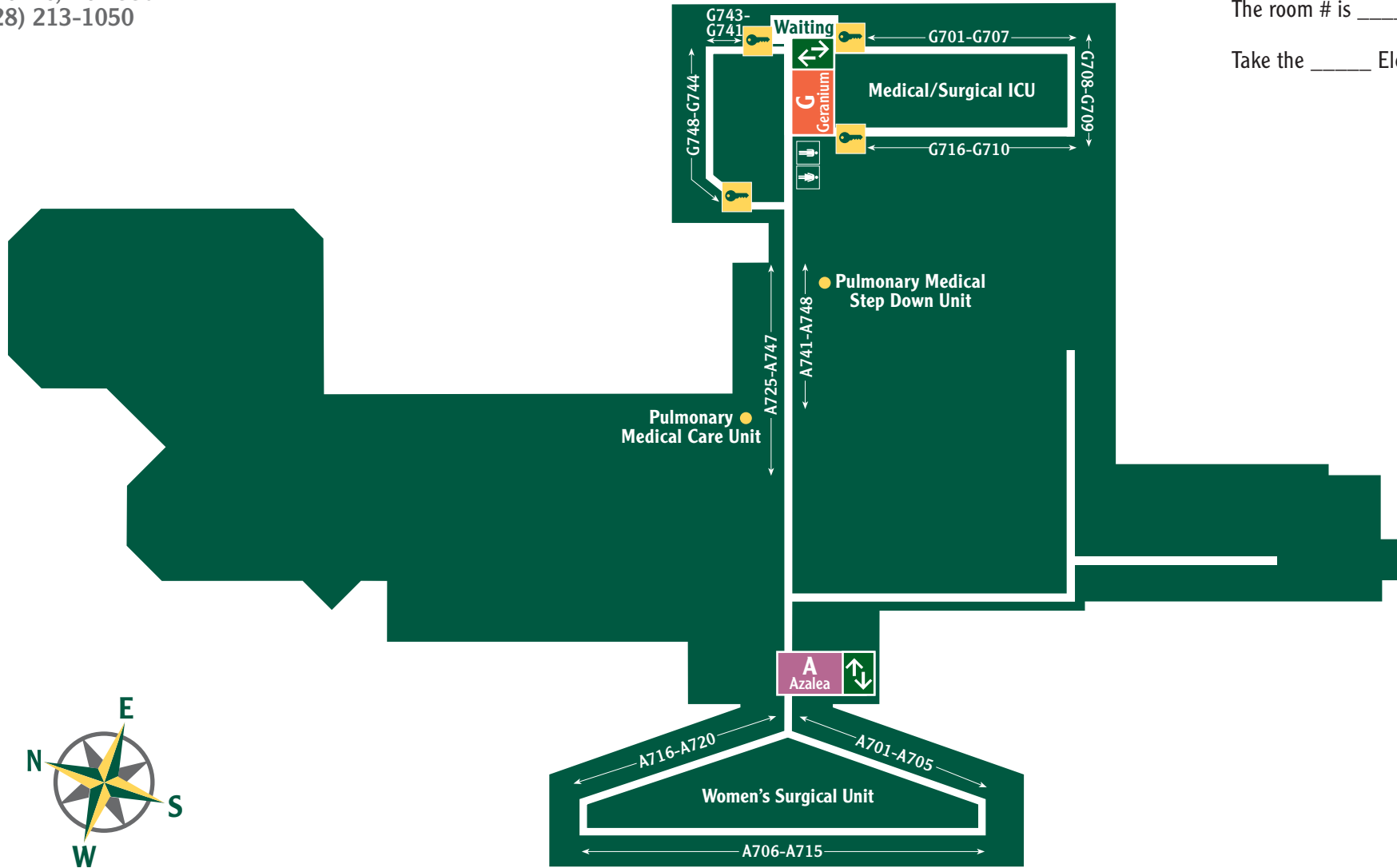

Azalea	Evergreen	Geranium	Building Entrance	Emergency Entrance	Emergency	Information	Cafeteria	Restrooms	Secure Access	Retail Pharmacy	Gift Shop	Bean Shop	ATM	Internet Access	Parking	Campus Shuttle

Memorial Campus Elevator Guide



Use this elevator guide to help you reach your destination.

Patient Rooms

Destination	Elevator	Level
A301 – A340	A	3
A401 – A468	A	4
A501 – A568	A	5
A601 – A640	A	6
A701 – A750	A	7
B570 – B586	A	5
B670 – B695	A	6
C469 – C479	A	4
C493 – C496	A	4
C587, C589, C591, C593	A	5
C590 – C599	G	5
D351 – D360	G	5
E352-E388	E	3
E368-E388	E	3
E401-E440	E	4
E501-E540	E	5
G370 – G399	G	3
G480 – G496	G	4
G501 – G526	G	5
G741 – G748	G	7

Phone Guide

To call a patient's room on the Memorial Campus dial:
 For A, B, C rooms dial 213 + 6 + ROOM NUMBER
 For E rooms dial 213 + 7 + ROOM NUMBER
 For G rooms dial 213 + 8 + ROOM NUMBER
 Guest Services Desk: 213-1001, 213-1002, or 213-1003
 Patient Information: 213-1050
 For long distance calls, begin with area code (828).

Units and Departments

Destination	Elevator	Level
AM Admitting	G	2
Cardiology ICU	E	3
Cardiology Stepdown	E	5
Cardiovascular Progressive Care	E	4
Cardiovascular ICU	E	3
Children's Dental Surgery	A	3
Emergency	G	2
Endoscopy	A	3
Heart Center	E	1
General Medicine	A	3
General Surgery	A	4
Hemodialysis	A	4
Labor & Delivery	G	4
Maternal Fetal Medicine Unit	A	4
Medical Cardiology Stepdown	A	3
Medical Surgical ICU	G	7
Mission Children's Hospital	G	3
Mother/Baby Unit	G	5
Neonatal ICU	G	6
Neurosciences Unit	A	6
NeuroTrauma ICU	E	3
Outpatient Catheterization	A	3
Patient/Outpatient Registration	G	2
PASU	A	5
Pediatric ICU	G	3
Pulmonary Medical Care Unit	G	17
Radiation Therapy	G	1
Same Day Discharge Unit	A	5
Spine Center	A	6
Trauma Care Unit	A	5
WNC Breastfeeding Center	G	6
Women's Health Center	G	5
Women's Surgical Unit	A	7

Waiting Rooms

Destination	Elevator	Level
Cardiology Waiting	A	3
Fullerton Waiting	A	3
Heart Center Waiting	E	1
SDDU Waiting	A	5
Spine Center Waiting	A	6
Surgery Waiting	A	1
Labor and Delivery Waiting	G	4
Neonatal ICU Waiting	G	6
Pediatric ICU Waiting	G	3
Radiology Waiting	A	2
Other		
Access to E elevator/Heart Center	A	3
Administration	A	2
Bean Shop	A	1
Cafeteria	A	2
Chapel	A	3
Family Consultation Rooms A, B & C	E	2
Gift Shop	A	1
Glenn Theater	E	2
Health Information Management	G	1
Heart Center Chapel	E	1
Heart Center Information	E	1
Information	A	1
Kate B. Reynolds Classrooms A & B	G	1
Neonatal ICU Sleep Rooms	A	6
Pastoral Care	A	3
Pharmacy	G	1
Stevens Board Room	E	2
Volunteer Classroom	A	1
Volunteer Services	A	1
Women's Classroom B416	A	4